



DADEVILLE FIRE DEPARTMENT  
339 NORTH TALLASSEE STREET  
DADEVILLE, ALABAMA 36853  
SCOTT ATKINS, FIRE CHIEF  
(256) 825-8534



The City of Dadeville Fire Department is seeking sealed  
BIDs on a metal building for the  
Dadeville Fire Station #2

All sealed BIDs are required to be at:  
Dadeville City Hall  
Attention: City Clerk  
265 N Broadnax Street  
Dadeville, Alabama 36853  
by:  
9 a.m. on Monday, October 28, 2024  
for opening and awarding

If interested in bidding, the specifications can be seen on  
the city website at [www.cityofdadevilleal.org](http://www.cityofdadevilleal.org) or by email  
request [cityclerk@cityofdadevilleal.org](mailto:cityclerk@cityofdadevilleal.org)

Published: The Dadeville Record 10/17/24, 10/24/24

10-9-24

Quote RefNo : \_\_\_\_\_ Quote Date : \_\_\_\_\_ Good Thru : \_\_\_\_\_  
Purchaser : DADEVILLE FIRE DEPARTMENT Primary Contact : Scott Atkins, Fire Chief  
Address : TBD City : DADEVILLE  
County : TALLAPOOSA Phone : (256) 825-8534 Email : satkins2115@gmail.com  
State : AL Cell : (256) 307-2736 Sales Rep : \_\_\_\_\_  
Zip : 36853 Fax : \_\_\_\_\_ Building : 1 OF 1

Ship To : TBD County : TALLAPOOSA  
City : DADEVILLE State : AL Zip : 36853

**CUSTOMER IS HEREBY PRESENTED A PROPOSED CONTRACT FOR THE STEEL BUILDING BELOW:**

Width : 48' Length : 48' Eave Height : 16'  
Building Profile : GABLE Roof Pitch : 2:12  
Bay Spacing : 19'6, 28'6 Column Type : PER DESIGN Girt Condition : SW:BYPASS  
EW:FLUSH  
Roof Type : 26 GA PBR Roof Sheet Gauge : 26 Wall Sheet Gauge : 26  
Code : IBC 2021 Wind Load : 125 EX B Snow Load : 5  
Collateral Load : 1# ROOF Live Load : 20 Reducible : NO  
Roof Color : GALVALUME Wall Color : CHOICE Rake & Eave Trim Color : CHOICE  
Framed Opening Trim Color : CHOICE Corner Trim Color : CHOICE Gutters & Down Spouts Color : CHOICE

Special Specifications : \_\_\_\_\_

Anchor Bolt Drawings, Stamped Certified Drawings : State of AL

**ACCESSORIES FOR BUILDING**

Quote RefNo :	Purchaser : <u>DADEVILLE FIRE DEPARTMENT</u>	BASE PRICE :
QUANTITY	DESCRIPTION	ADD'L PRICE
2	WALK IN DOORS 3070 W/PANIC HDW/CLOSER	
ROOF & WALLS	SQ FEET OF INSULATION 6" ROOF 4"WALLS WHITE VINYL REINFORCED	
2	LARGE DOORS ROLL UP WITH HEADER SEAL 12 X 14	
2	FRAMED OPENINGS FULL COVER TRIM 12 X 14	
	EAVE CONDITION GUTTER AND DOWNSPOUTS	
	BASE CONDITION BASE ANGLE W/TRIM	
	FASTENERS LONG LIFE	
1	OTHER ITEM : SEALED FOUNDATION PLANS - 6" SLAB	
	OTHER ITEM : BUILDING DESIGNED AS CATEGORY IV ESSENTIAL FACILITY	
	OTHER ITEM : WALK DOORS TO HAVE PANIC/CLOSERS	
1	OTHER ITEM : 5' PROJECTION X 16' LONG BELOW EAVE OVERHANG ON RIGHT ENDWALL WITH SOFFIT TO FOLLOW THE SLOPE	
2	OTHER ITEM : ROLL UP DOORS TO HAVE MOTOR/REMOTE	
<b>BUILDING &amp; ACCESSORIES SUBTOTAL</b>		
OTHER : EXEMPT // RESALE		
<b>TOTAL :</b>		

ADD \$      FOR GUTTER/DOWNS TO 5' BELOW EAVE OVERHANG ON RIGHT ENDWALL ADD  
 FOR 26GA PBR STANDARD COLOR LINER TO 8' FULL PERIMETER ADD      FOR A 5'  
 EAVE EXTENSION AT FRONT SIDEWALL, FULL LENGTH WITH SOFFIT, GUTTER & DOWNSPOUT (YOU  
 WILL HAVE ABOUT 14'3" +/- CLEAR UNDER THE END OF THE OVERHANG)

Additional information :

30% of Contract Price Due Upon  
 Acceptance :

Balance due in Cashiers Check Prior to  
 Unloading :

Quote RefNo : Purchaser : DADEVILLE FIRE  
DEPARTMENT

Estimated Delivery . \_\_\_\_\_

Accepted by Purchaser this \_\_\_\_\_ day of \_\_\_\_\_ 2024

Print Name : \_\_\_\_\_

X \_\_\_\_\_

**TOTAL MATERIAL PRICE :**

LABOR IS NOT INCLUDED IN TOTAL MATERIAL PRICE: \_\_\_\_\_

LABOR BY OTHERS

**FOR OFFICE USE ONLY**

X \_\_\_\_\_

Approved and Accepted by \_\_\_\_\_

\_\_\_\_\_ Title

\_\_\_\_\_ day of \_\_\_\_\_ 2024

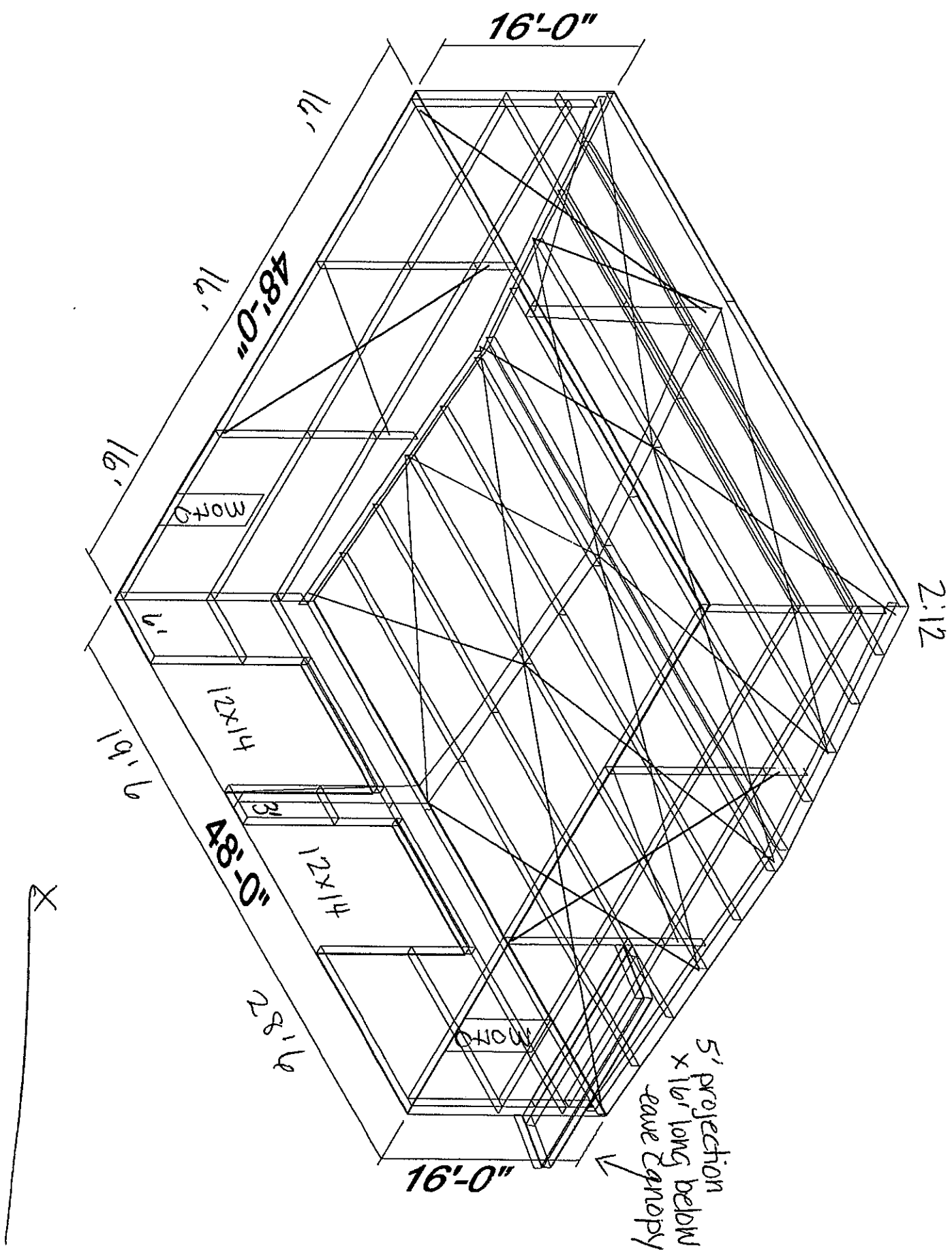

\* AS CURRENTLY QUOTED

\* Alternate - to incl. 16'-0"  
 liner panel to 8', full perimeter 16'-0"

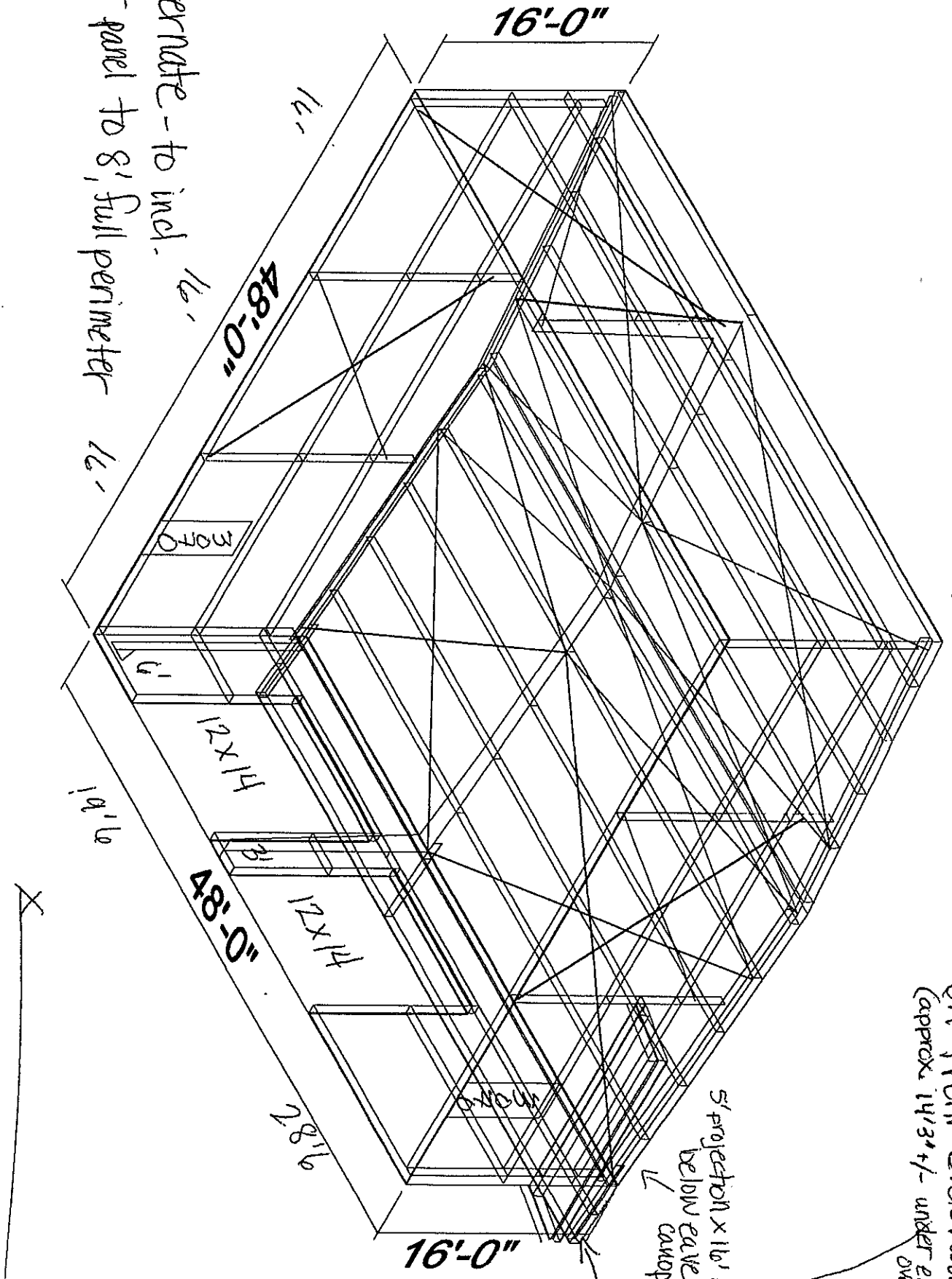

2:12

\* Alternate with 5' overhang  
 on front sidewall -  
 (approx 14'3" +/- under end of  
 overhang)

5' projection x 16' long  
 below eave  
 below canopy